

Kombinat Fortschritt Landmaschinen

**VEB Metallwarenfabrik  
6850 Lobenstein (Thür.)**

## **Einzelteilliste**

**Fahrzeugwaschpumpe AS 22/6 k**

## **List of parts**

**Horizontal single-acting triple-throw pump**

## **Lista de pieza**

**Bomba para el lavado de vehiculos AS 22/6 k**

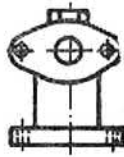
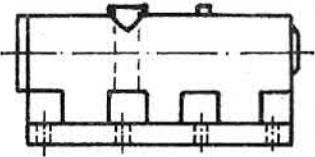
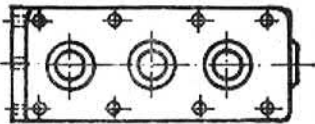

Ansaugflansch  
 Suction connection  
 Brida de aspiración

10.02



7 St. Ventilkegel\*  
 7 valve cones\*  
 7 machos de válvula\*

10.04



7 St. Ventilsitzring\*  
 7 valve seat rings\*  
 7 asientos de válvula\*

10.05

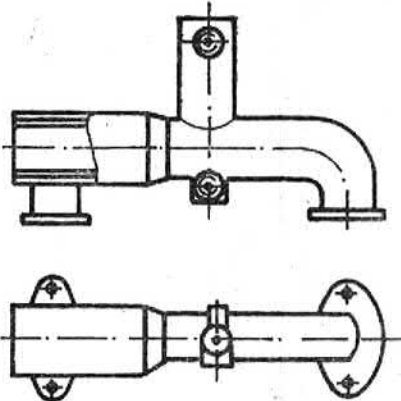

Verteilerstück  
 Header  
 Cuerpo de distribución

23.01

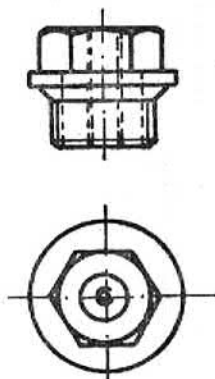

Verschlußstopfen  
 Drain plug  
 Tapón de cierre

23.05



Federteller  
Spring collar  
Platillo de resorte

23.07

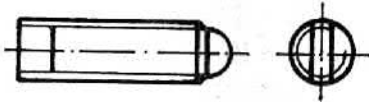

Schaftschraube  
Headless screw  
Tornillo de vástago

10.09

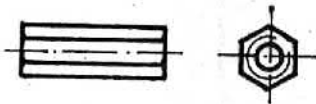

Hutmutter  
Cap nut  
Tuerca de sombrerete

10.08

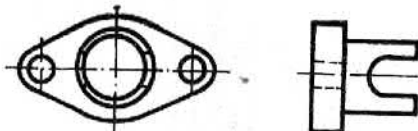

3 St. Zylinderflansch  
3 cylinder flanges  
3 bridas de cilindro

12.14



3 St. Ventilverschlußstopfen  
3 valve drain plugs  
3 tapones de cierre de válvula

10.11

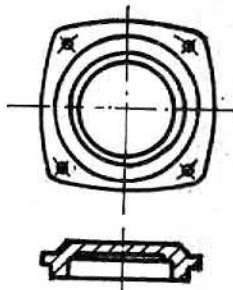

Lagerverschlußdeckel  
Bearing cap  
Tapa de cojinete

12.05

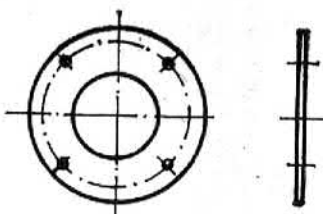

Blechscheibe  
Washer  
Disco de chapa

12.02

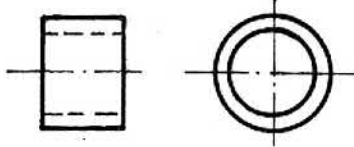

Laufring  
Anillo de rodadura

12.04

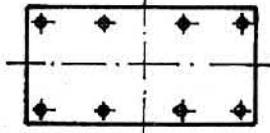

Deckel, hinten  
Back cover  
Tapa trasera

10.32

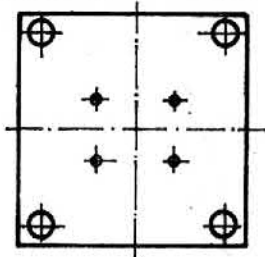

Deckel, oben  
Top cover  
Tapa superior

11.03

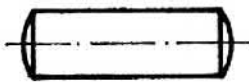

3 St. Kolbenbolzen  
3 gudgeon pins  
3 bulones de émbolo

4/33

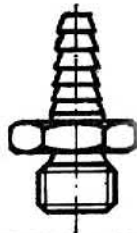

Schlauchanschluß ½"  
Hose connection ½"  
Racor para tubo flexible ½"

23.01

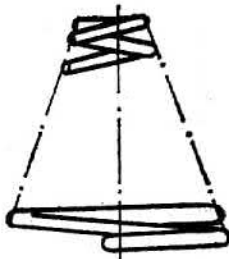

6 St. Ventilfeder\*  
6 valve springs\*  
6 resortes de válvula\*

10.06

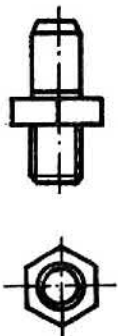

2 St. Schlauchanschluß ¾"  
2 hose connections ¾"  
2 racores para tubo flexible ¾"

21.03

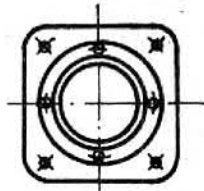

Lagerdeckel  
 Tapa de cojinete

12.23

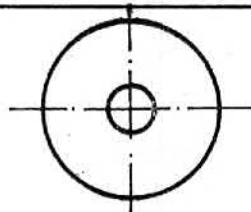
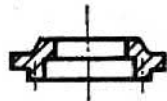

2 St. Endscheibe  
 end disk  
 2 discos finales

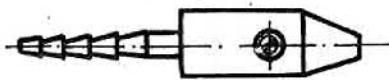

Spritzpistole  
 Spray nozzle  
 Tobera de proyección

30.00

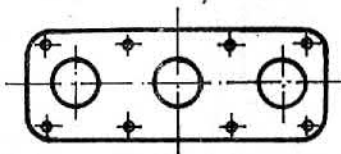

Dichtung  
 Packing  
 Junta

10.03

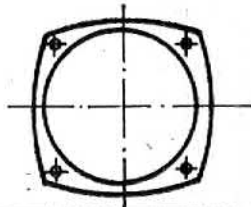

Dichtung  
 Packing  
 Junta

12.06



Dichtung  
 Packing  
 Junta

10.33

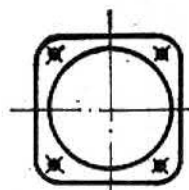

Dichtung  
 Packing  
 Junta

12.27

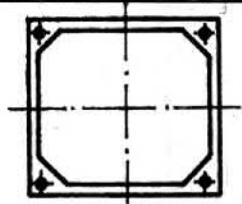

Dichtung  
Packing  
Junta

11.06

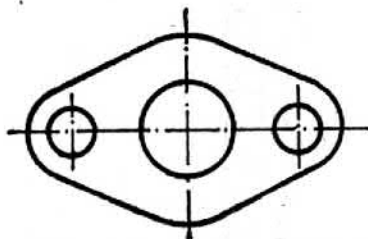

2 St. Dichtung  
2 packings  
2 juntas

23.02

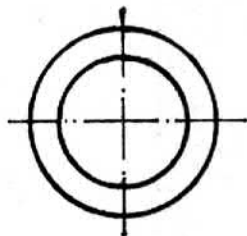

2 St. Dichtung  
2 packings  
2 juntas

26 × 35

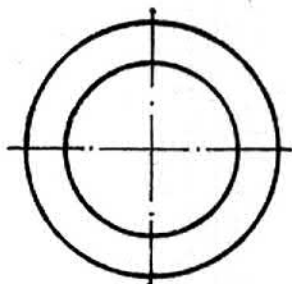

Dichtung  
Packing  
Junta

23.06